

## VR10000s WINCH

**Part Number:** 87840

**Rated Line Pull:** 10000 lbs. (4536 kgs)

**Motor:** 12V DC, Series Wound

**Controls:** Remote switch, 12" (3.7m) Lead

**Gear train:** 3-Stage Planetary

**Gear Ratio:** 261:1

**Clutch (Freespool):** Sliding Ring Gear

**Brake:** Automatic Direct Drive Cone

**Drum diameter/length:** 2.625"/9.0" (6.7cm/23cm)

**Kit Shipping Weight:** 89 lbs. (40.4 kgs)

**Rope:** Spydura™ Synthetic Rope, Ø 3/8" x 100' (Ø 9.5mm x 30.5m)

**Fairlead:** Polished Hawse

**Recommended Battery:** 650CCA Minimum for winching

**Duty Cycle:** Intermittent

**Battery leads:** 2 gauge, 72" (1.83m)

**Finish:** Black Powder Coat

**Warranty:** Limited Lifetime

**Mounting Bolt Pattern:** 10.0" x 4.5" (254mm x 114.3mm)

**Winch Dimensions:** 20.80" L x 6.3" D x 6.97" H (528mm L x 160mm D x 177mm H)

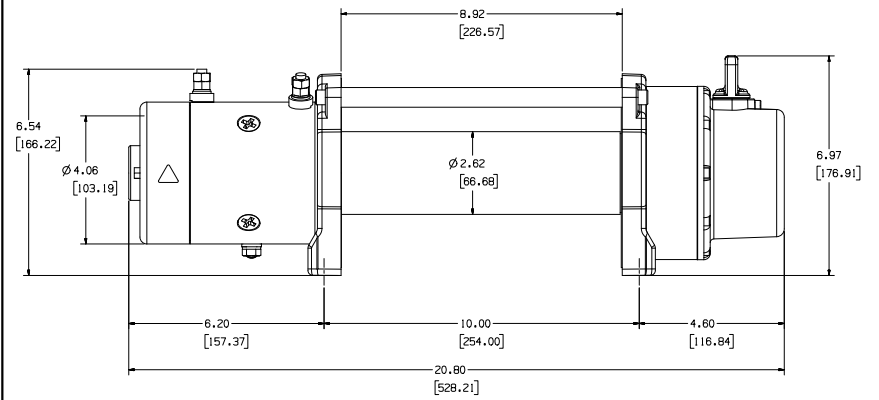

## SERVICE INSTRUCTIONS

Should you encounter a problem during installation or operation of your winch, please follow these steps toward resolving the problem:

1. Refer to your operator's guide and installation instructions. It has illustrations and detailed information on the installation and safe and proper operation of your winch. It also includes a replacement parts list and assembly diagrams. If you are unable to resolve the problem, then go to step 2.
2. Contact your dealer where you purchased your winch. If, after discussing the problem with their parts and service staff, you are still unable to resolve the problem then go to step 3.
3. Call an Authorized WARN Service center from the list provided on the back of the warranty sheet included with the product. When calling, please have the following information available: winch model number and purchase date, make, model and year of vehicle.
4. If you are unable to resolve the problem to your satisfaction, please call Warn Industries Customer Service at: 1-800-543-9276. When calling, please have the following information available: winch model number and purchase date, make, model and year of vehicle. You may also contact Warn Industries by visiting our website: [www.warn.com](http://www.warn.com)

## SERVICE/UPGRADE KITS

KIT#	PN	ITEM	QTY	DESCRIPTION
KIT 1	92083	1	1	END HOUSING KIT
		2	1	END HOUSING
		3	1	CLUTCH LEVER
		4	1	SEAL, O-RING
		5	1	CLUTCH LEVER DETENT SCREW
		6	10	RING GEAR, SLIDING
		7	1	CAPSCREW, 10-24
		8	1	GASKET
KIT 2	92077	21	1	THRUST WASHER
		22	1	DRUM SUPPORT KIT
		23	2	GEAR SIDE DRUM SUPPORT
KIT 3	86473	24	2	MOTOR SIDE DRUM SUPPORT
		25	4	BUSHING
				TIE ROD KIT
		24	2	TIE ROD
		25	4	5/16" BOLTS

KIT#	PN	ITEM	QTY	DESCRIPTION
KIT 4	92079	7	1	RING GEAR KIT
		13	1	GASKET
		14	1	CARRIER ASSEMBLY, STAGE 3
		33	1	RING GEAR
KIT 5	92085	33	1	SPLINED DRIVE GEAR
		10	1	CARRIER KIT
		11	1	SUN GEAR
		12	1	CARRIER ASSEMBLY, STAGE 1
KIT 6	32455	32	1	CARRIER ASSEMBLY, STAGE 2
		30	1	SHAFT, DRIVE
		31	1	BRAKE KIT
		32	1	COUPLER
KIT 7	900548	33	1	BRAKE
		33	1	SHAFT, DRIVE
		40	1	SPLINED DRIVE GEAR
		45	1	MOTOR KIT
KIT 8	92073	40	1	MOTOR
		45	1	SPACER
		54	1	GROUND BOLT
		60	1	CONTROL PACK KIT
KIT 9	92069	60	1	CONTROL PACK
		62	1	SOLENOID
		65	1	BRACKET
		6	10	BOLT AND GASKET KIT
KIT 10	92066	7	2	CAPSCREW, 10-24
		8	1	GASKET
		23	2	THRUST WASHER
		25	4	BUSHING
		54	1	5/16" BOLTS
		55	1	GROUND BOLT
		55	1	PARTS PACK
INDIVIDUAL ITEMS				
		87689	26	DRUM ASSEMBLY
		87915	27	SYNTHETIC ROPE
		76226	28	TERMINAL KIT
		15901	53	GROUND CABLE
		90172	65	BRACKET
		38626	68	REMOTE ASSEMBLY
		87914	80	FAIRLEAD, HAWSE